

22 BR Remington

Test Specifications/ Components

Firearm Used: Savage Model 11

Barrel Length: 26"

Twist: 1 x 8"

Case: Remington (reformed)

Trim-to Length: 1.510"

Primer: Rem 7 1/2

Remarks:

The 22 Remington Bench Rest today serves as good proof that a cartridge's own excellence isn't necessarily a guarantee of success. Originally championed by the winning competitive benchrest duo from Remington, Mike Walker and Jim Stekl, the 22 BR was the smallest of the BR family of cases

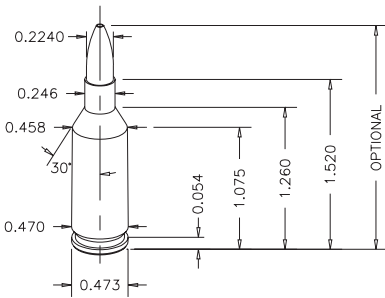

introduced in the early 1970s. This was a time of monumental changes in the benchrest world, and the 22 BR became something of a casualty of events. For some years prior, there had been a shift to the 6mm bore size to take advantage of the slightly better ballistics. Most of the development in this field was centered around the tried and true 222 Remington. Enter the Remington Bench Rest (BR) cartridges. Capable of delivering better accuracy than the 222, the new BR cartridges promised to become the new standard for this game. Unfortunately for the Remington twins, another pair of cartridges appeared at almost the same instant—the 22 and 6mm PPCs. Since then, the 6mm PPC has dominated the benchrest world, replacing virtually all other cartridges.

Despite ballistic performance that rivals the 22-250 and accuracy potential that matches that of the PPC cartridges, the 22 BR has been all but forgotten. It was never offered as a true - both rifles and ammunition being commercially manufactured - factory chambering. This is unfortunate, since it has all the attributes of a real crowd pleaser. In our work, it proved to be a flexible little number, giving excellent to outstanding accuracy with a variety of loadings. Case forming had been a chore, but this is not necessarily true anymore. While the case was originally based on a special, small primered 308 Winchester case, both 6mm and 7mm BR brass is readily available today. These, particularly the 6mm, will be much easier to reform into 22 BR cases than the original parent case. Reloading dies and chambering reamers are available from all major manufacturers. For the avid varminteer trying to decide on a new custom rifle, the 22 BR deserves some serious consideration.

22 BR Remington continued

#1385 .224" 40 gr. HP
C.O.A.L. 1.940"



#1440 .224" 40 gr. BlitzKing
C.O.A.L. 1.955"



Powder↓/Velocity→	3500	3600	3700	3800	3900	4000	4100
IMR-4198	24.7	25.4	26.1	26.8	27.5		
XMR-2015	28.0	28.8	29.6	30.4	31.2	32.0	
RE-7	24.9	25.7	26.5	27.3	28.1	28.9	
IMR-3031	29.0	29.6	30.2	30.8	31.4	32.0	
Benchmark	29.4	30.1	30.8	31.5	32.2	32.9	33.6
H322	28.1	28.9	29.7	30.5	31.3	32.1	32.9
X-Terminator	28.2	29.0	29.8	30.6	31.4	32.2	33.0
AA-2230	29.5	30.3	31.1	31.9	32.7	33.5	34.3
748	31.6	32.4	33.2	34.0	34.8	35.6	36.4
Viht N135	29.2	29.9	30.6	31.3	32.0	32.7	33.4
Varget	31.7	32.4	33.1	33.8	34.5		
Energy/ft.lbs.	1088	1151	1216	1282	1351	1421	1493

	Powder	Grains	Velocity	Ft. lbs.
Accuracy Load	IMR-4198	27.5	3900	1351
Hunting Load	RE-7	28.9	4000	1421

#1310 .224" 45 gr. SPT
C.O.A.L. 1.995"



Powder↓/Velocity→	3400	3500	3600	3700	3800	3900
IMR-4198	23.7	24.6	25.5	26.4	27.3	28.2
XMR-2015	27.4	28.2	29.0	29.8	30.6	31.4
RE-7	24.0	24.9	25.8	26.7	27.6	28.5
IMR-3031	28.2	28.9	29.6	30.3	31.0	31.7
Benchmark	27.8	28.6	29.4	30.2	31.0	31.8
H322	27.0	27.9	28.8	29.7	30.6	31.5
X-Terminator	26.6	27.7	28.8	29.9	31.0	
AA-2230	27.9	28.9	29.9	30.9	31.9	32.9
748	29.7	30.8	31.9	33.0	34.1	35.2
Viht N135	27.4	28.3	29.2	30.1	31.0	31.9
Varget	30.4	31.2	32.0	32.8	33.6	34.4
Energy/ft.lbs.	1155	1224	1295	1368	1443	1520

	Powder	Grains	Velocity	Ft. lbs.
Accuracy Load	IMR-3031	31.0	3800	1443
Hunting Load	H322	31.5	3900	1520

INDICATES MAXIMUM LOAD – USE CAUTION
LOADS LESS THAN MINIMUM CHARGES SHOWN ARE NOT RECOMMENDED.

22 BR Remington continued

#1320 .224" 50 gr. SMP
C.O.A.L. 1.985"



#1330 .224" 50 gr. SPT
C.O.A.L. 1.995"



#1340 .224" 50 gr. Blitz
C.O.A.L. 1.995"



#1450 .224" 50 gr. BlitzKing
C.O.A.L. 2.005"



Powder ↓/Velocity →	3200	3300	3400	3500	3600	3700	3750
XMR-2015	25.8	26.7	27.6	28.5	29.4		
RE-7	22.3	23.3	24.3	25.3	26.3		
IMR-3031	26.4	27.2	28.0	28.8	29.6		
Benchmark	26.2	27.1	28.0	28.9	29.8	30.7	31.1
H322	25.5	26.4	27.3	28.2	29.1	30.0	
X-Terminator	25.1	26.2	27.3	28.4	29.5		
AA-2230	26.2	27.3	28.4	29.5	30.6	31.7	
748		28.9	30.1	31.3	32.5	33.7	
IMR-4895	27.8	28.6	29.4	30.2	31.0		
Viht N135	25.3	26.4	27.5	28.6	29.7	30.8	
Varget	28.2	29.1	30.0	30.9	31.8	32.7	
Energy/ft.lbs.	1137	1209	1283	1360	1439	1520	1561

	Powder	Grains	Velocity	Ft. lbs.
Accuracy Load	Benchmark	30.7	3700	1520
Hunting Load	Benchmark	31.1	3750	1561

INDICATES MAXIMUM LOAD – USE CAUTION
LOADS LESS THAN MINIMUM CHARGES SHOWN ARE NOT RECOMMENDED.

22 BR Remington continued

#1410 .224" 52 gr. HPBT MatchKing
C.O.A.L. 1.980"



#1400 .224" 53 gr. HP MatchKing
C.O.A.L. 1.980"



Powder↓/Velocity→	3200	3300	3400	3500	3600	3700
XMR-2015	25.4	26.4	27.4	28.4		
RE-7	22.6	23.6	24.6	25.6		
IMR-3031	26.5	27.3	28.1	28.9		
Benchmark	25.6	26.6	27.6	28.6	29.6	
H322	24.9	26.0	27.1	28.2	29.3	
X-Terminator	25.7	26.7	27.7	28.7		
AA-2230	26.4	27.5	28.6	29.7	30.8	
748	28.6	29.6	30.6	31.6	32.6	
IMR-4895	27.5	28.3	29.1	29.9	30.7	31.5
Viht N135	25.9	27.0	28.1	29.2	30.3	31.4
Varget	28.0	29.0	30.0	31.0	32.0	33.0
Energy/ft.lbs.	1205	1281	1360	1442	1525	1611

	Powder	Grains	Velocity	Ft. lbs.
Accuracy Load	Benchmark	29.6	3600	1525

Sierra does not recommend MatchKing bullets for hunting applications.

INDICATES MAXIMUM LOAD – USE CAUTION
LOADS LESS THAN MINIMUM CHARGES SHOWN ARE NOT RECOMMENDED.

22 BR Remington continued

#1345 .224" 55 gr. Blitz
C.O.A.L. 1.995"



#1350 .224" 55 gr. SMP
C.O.A.L. 1.980"



#1355 .224" 55 gr. FMJBT
C.O.A.L. 1.995"



#1360 .224" 55 gr. SPT
C.O.A.L. 1.995"



#1365 .224" 55 gr. SBT
C.O.A.L. 1.995"



#1390 .224" 55 gr. HPBT
C.O.A.L. 1.935"



#1455 .224" 55 gr. BlitzKing
C.O.A.L. 2.020"



55 grain BlitzKing requires a 1x12" or faster barrel

Powder ↓/Velocity →	3200	3300	3400	3500	3600	3700	3750
XMR-2015	26.0	27.0	28.0	29.0	30.0		
RE-7	23.2	24.2	25.2	26.2	27.2		
IMR-3031	26.6	27.5	28.4	29.3	30.2	31.1	
Benchmark	26.8	27.8	28.8	29.8	30.8		
H322	25.8	26.8	27.8	28.8	29.8	30.8	
X-Terminator	26.1	27.2	28.3	29.4	30.5		
AA-2230	27.3	28.3	29.3	30.3	31.3	32.3	32.8
748	28.4	29.5	30.6	31.7	32.8	33.9	34.4
IMR-4895	28.0	28.9	29.8	30.7	31.6	32.5	
Viht N135	26.4	27.5	28.6	29.7	30.8		
Varget	28.5	29.5	30.5	31.5	32.5	33.5	
Energy/ft.lbs.	1250	1330	1412	1496	1583	1672	1717

	Powder	Grains	Velocity	Ft. lbs.
Accuracy Load	H322	29.8	3600	1583
Hunting Load	H322	30.8	3700	1672

INDICATES MAXIMUM LOAD – USE CAUTION
LOADS LESS THAN MINIMUM CHARGES SHOWN ARE NOT RECOMMENDED.

22 BR Remington continued

#1375 .224" 60 gr. HP
C.O.A.L. 2.020"



#1370 .224" 63 gr. SMP
C.O.A.L. 1.995"



Powder↓/Velocity→	2900	3000	3100	3200	3300	3400	3450
IMR-3031	23.6	24.6	25.6	26.6	27.6	28.6	29.1
Benchmark	23.2	24.2	25.2	26.2	27.2	28.2	28.7
H322	22.9	24.0	25.1	26.2	27.3	28.4	
X-Terminator	24.0	25.2	26.4	27.6	28.8		
AA-2230	23.9	25.1	26.3	27.5	28.7		
748	25.5	26.6	27.7	28.8	29.9	31.0	
AA-2460	25.0	26.1	27.2	28.3	29.4	30.5	
IMR-4895	25.0	26.0	27.0	28.0	29.0	30.0	
Viht N135	23.4	24.6	25.8	27.0	28.2		
Varget	24.8	25.9	27.0	28.1	29.2	30.3	
Energy/ft.lbs.	1176	1259	1344	1432	1523	1617	1665

	Powder	Grains	Velocity	Ft. lbs.
Accuracy Load	IMR-4895	29.0	3300	1523
Hunting Load	H322	28.4	3400	1617

#1380 .224" 69 gr. HPBT MatchKing
C.O.A.L. 2.020"
requires a 1x10" twist barrel or faster



Powder↓/Velocity→	2800	2900	3000	3100	3200	3250	3300
IMR-3031	23.5	24.6	25.7	26.8	27.9	28.4	
Benchmark	23.4	24.6	25.8	27.0	28.2		
H322	23.4	24.5	25.6	26.7	27.8		
X-Terminator	23.2	24.4	25.6	26.8	28.0	28.6	29.2
AA-2230	23.7	24.9	26.1	27.3	28.5		
748	26.0	27.1	28.2	29.3	30.4	30.9	
AA-2460	24.7	25.8	26.9	28.0	29.1	29.6	30.2
IMR-4895	24.9	25.9	26.9	27.9	28.9		
Viht N135	23.1	24.3	25.5	26.7	27.9		
Varget	24.3	25.6	26.9	28.2	29.5	30.1	30.8
Energy/ft.lbs.	1201	1288	1379	1472	1569	1618	1668

	Powder	Grains	Velocity	Ft. lbs.
Accuracy Load	Varget	30.1	3250	1618

Sierra does not recommend MatchKing bullets for hunting applications.

INDICATES MAXIMUM LOAD – USE CAUTION
LOADS LESS THAN MINIMUM CHARGES SHOWN ARE NOT RECOMMENDED.

22 BR Remington continued

#9390 .224" 80 gr. HPBT MatchKing

C.O.A.L. 2.160"

requires a 1x8" twist barrel or faster



Powder ↓/Velocity →	2600	2700	2800	2900	3000	3050
IMR-3031	22.2	23.4	24.6	25.8	27.0	
Benchmark	21.6	23.0	24.4	25.8	27.2	
H322	21.6	22.9	24.2	25.5	26.8	
X-Terminator	22.1	23.4	24.7	26.0	27.3	
AA-2230	22.4	23.6	24.8	26.0	27.2	
748	24.2	25.4	26.6	27.8	29.0	29.6
AA-2460	22.8	24.1	25.4	26.7	28.0	28.6
IMR-4895	23.5	24.7	25.9	27.1	28.3	
Viht N135	21.8	23.2	24.6	26.0		
Varget	23.1	24.4	25.7	27.0	28.3	
Energy/ft.lbs.	1201	1295	1393	1494	1599	1652

	Powder	Grains	Velocity	Ft. lbs.
Accuracy Load	Varget	28.3	3000	1599

Sierra does not recommend MatchKing bullets for hunting applications.

INDICATES MAXIMUM LOAD – USE CAUTION

LOADS LESS THAN MINIMUM CHARGES SHOWN ARE NOT RECOMMENDED.